

H 8123 CEILING MOUNT

FOR LCD, PLASMA, and LED DISPLAYS

INSTRUCTION MANUAL

SPECIFICATIONS

Display Size: 37" to 60"

Maximum Load: 75 kg (165 lbs)

Mounting Pattern: 800 mm x 500 mm (31.5" x 19.7") max

Tilt Range: Up to 15° down

Pan/Swivel Range: Up to 130°

Distance from Ceiling: 102.4 cm to 122.4 cm (40.3" to 48.2")

BOX CONTENTS

- Upper Extension Pipe (x1)
- Lower Extension Pipe (x1)
- Mount (x1)
- Mount Arm (x2)
- Instruction Manual (x1)
- Hardware Kit (x1)

WARNINGS

- 1** Read these instructions before you begin. If you are unsure of any part of the process, contact a professional contractor or installer for assistance. Improper installation can result in injury or damage.
- 2** The ceiling or mounting surface must be capable of supporting the combined weight of the mount and the display; if not, the structure must be reinforced.
- 3** Locate pipes, wires, or any other hazards in the area where you wish to install the mount before drilling.
- 4** Safety gear and proper tools must be used. Failure to do so can result in injury or damage.
- 5** A minimum of two people are required for installation. Do not attempt to install this mount alone under any circumstances.
- 6** Follow all instructions and recommendations regarding adequate ventilation and suitable locations for mounting your display. Consult the owner's manual for your particular display for more information.

CAUTION: This wall mount is intended for use only with the maximum weight of 75 kg (165 lbs). Use with more than the maximum weights indicated may result in instability causing possible injury.

TOOLS REQUIRED

- Phillips Head Screw Driver
- Ratchet or Driver with 17 mm Socket
- Electric or Portable Drill
- 6 mm (1/4") Drill Bit and Stud Finder for Drywall Installation
- 12 mm (7/16") Masonry Bit for Concrete Installation

HARDWARE KIT

- | | |
|----------------------------|--------------------------------|
| (A) M10 x 80 Lag Bolt (x4) | (H) M6 Washer (x4) |
| (B) Lag Bolt Washer (x4) | (I) Spacer (x8) |
| (C) Concrete Anchor (x4) | (J) M8 x 70 Carriage Bolt (x2) |
| (D) M6 x 12 Screw (x4) | (K) M8 Lock Nut (x2) |
| (E) M6 x 30 Screw (x4) | |
| (F) M8 x 12 Screw (x4) | |
| (G) M8 x 30 Screw (x4) | |

INSTALLATION

Part 1A –Mounting to the Ceiling (Drywall)

IMPORTANT! For safety reasons, this mount must be secured to a wooden ceiling joist. The joist must be capable of supporting the combined weight of the mount and display.

Part 1A –Mounting to the Ceiling (Drywall) (Continued)

- 1** Use a high quality stud finder to locate a ceiling joist where you wish to install your mount. Mark both edges of the joist to help identify the exact centre.
- NOTE:** You must use the centre of the joist to avoid cracking or splitting the wood during installation.
- 2** Place the upper extension pipe against the ceiling over the marked joist.
- 3** While another person holds the upper extension pipe in place, mark two locations for securing the mount to the ceiling (see Fig. 1).
- 4** Set the upper extension pipe aside and drill a 6 mm (1/4") pilot hole at each marked location.
- 5** Place the upper extension pipe back against the ceiling and attach it using the lag bolts (A) and lag bolt washers (B) provided (see Fig. 2). **Do not over-tighten these bolts and do not release the upper extension pipe until both bolts are secured.**

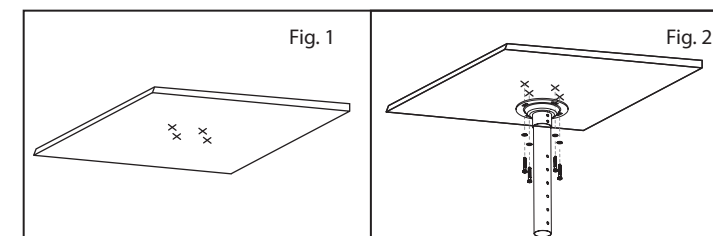

Part 1B –Mounting to the Ceiling (Concrete)

IMPORTANT! For safety reasons, the concrete ceiling must be capable of supporting the combined weight of the mount and the display. The manufacturer takes no responsibility for failure caused by a ceiling of insufficient strength.

- 1** Place the upper extension pipe against the ceiling in the desired location.
- 2** While another person holds the upper extension pipe in place, mark two locations for securing the mount to the ceiling.
- 3** Set the upper extension pipe aside and drill a 12 mm (7/16") hole at each marked location. Remove any excess dust from the holes (see Fig. 3).

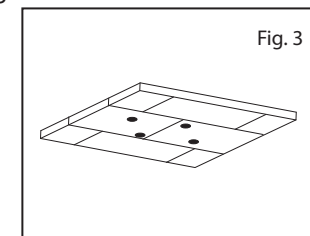

Part 1B – Mounting to the Ceiling (Concrete)(Continued)

- 4 Insert a concrete anchor (C) into each hole so that it is flush with the concrete surface (see Fig. 4). A hammer can be used to lightly tap the anchors into place if necessary.

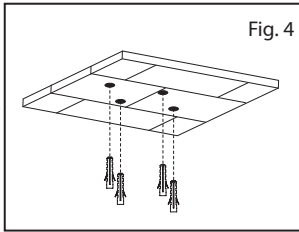

NOTE: If the concrete ceiling is covered by a layer of plaster or drywall, the concrete anchor must pass completely through the layer to rest flush with the concrete surface.

- 5 Place the upper extension pipe back against the ceiling and attach it using the lag bolts (A) and lag bolt washers (B) provided (see Fig. 2). Do not over-tighten these bolts and do not release the upper extension pipe until both bolts are in place.

Part 2 – Attaching the Mount Arms to the Display

IMPORTANT! Use extra care during this part of the installation. If possible, avoid placing your display facedown as it may damage the viewing surface.

NOTE: This mount comes with a selection of different screw diameters and lengths to accommodate a wide variety of display models. Not all of the hardware in the kit will be used. If you cannot find the appropriate screw size in the kit provided, consult the manufacturer of your display for more information.

- 1 Determine the correct length of screw to use by examining the back of your display:
 - A If the back of your display is flat and the mounting holes are flush with the surface, you will use the shorter screws (D or F) from the hardware kit.
 - B If the back of your display is curved, has a protrusion, or if the mounting holes are recessed, you will need to use the longer screws (E or G) and may also need to use the spacers (I).

- 2 Determine the correct diameter of screw to use by carefully trying one of each size (M6 and M8) from the hardware kit. **Do not force any of the screws – if you feel resistance stop immediately and try a smaller diameter screw.**

Part 2 – Attaching the Mount Arms to the Display (continued)

- 3 Attach the mount arms to the back of your display using the screws identified in Steps 1 and 2 (see Fig. 5):
 - A If you are using the M6 screws you will also need to use the M6 washers (H). M8 screws do not require washers.
 - B If you are using the longer screws on a display with a curved or recessed back, you may also need to use the spacers (I). Use one spacer or two spacers stacked as needed. **Only use a spacer if necessary.**

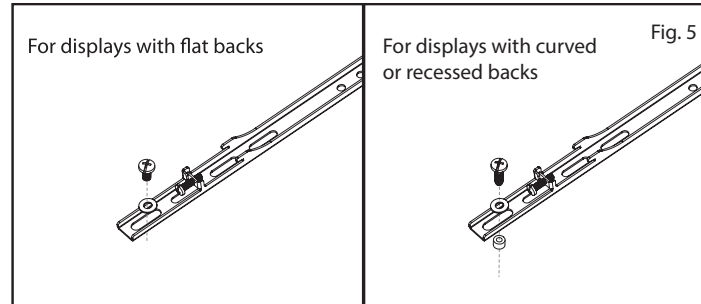

Part 3 – Final Assembly

- 1 Insert the lower extension pipe into the upper extension pipe as shown and adjust it to the desired height. Attach the lower extension pipe to upper extension pipe using the M8 x 70 carriage bolts (J) and M8 lock nuts (K) from the hardware kit (see Fig. 6). **Both of these bolts must pass through both the lower and upper extension poles.**

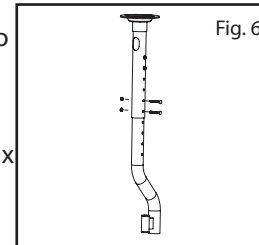

- 2 Remove the pre-assembled hardware from the mount (see Fig. 7)
- 3 Attach the mount to the lower extension pipe as shown in the illustration using the pre-assembled hardware from step 2 (see Fig. 8). **Make sure the mount is securely attached to the lower extension pipe.**

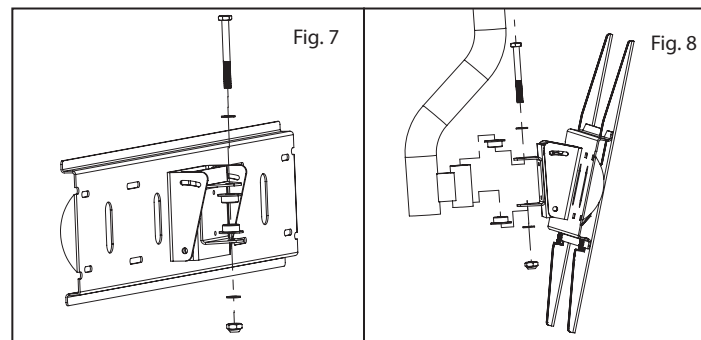

Part 3 – Final Assembly (continued)

- 4 With the help of another person, carefully lift your display and place it over the cross bars as shown in the illustration (see Fig. 9). **Do not release the display until both mount arms have securely hooked onto the mount.**
- 5 Tighten the safety screws located at the bottom of each mount arm to prevent (see Fig. 10) the display from being lifted from the mount.

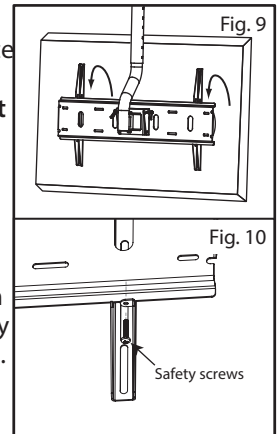

IMPORTANT! The safety screws must be tightened at all times to prevent the display from being accidentally knocked from the mount.

OPERATION AND ADJUSTMENT

- 1 Swivel adjustments can be made by simply moving your display to the desired position.
- 2 Change the tilt angle of your display, have one person hold the display firmly in place while another person loosens the tilt adjustment knobs located behind the mount. Move your display to the desired position and then re-tighten the knobs (see Fig. 11) **Do not release the display until the tilt adjustment knobs are firmly tightened.**
- 3 Periodically clean your mount with a dry cloth. Inspect all screws and hardware at regular intervals to ensure that no connections have become loose over time. Re-tighten as needed.

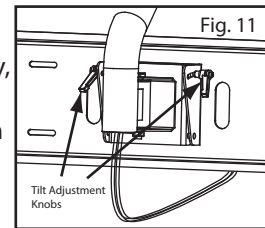

Imported by Altronic Distributors Pty. Ltd.

www.altronic.com.au

Made in China